

Existing Gound Floor Plan  
Scale 1:100 @ A3

9400

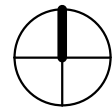

1

6021.6

Boundary Line

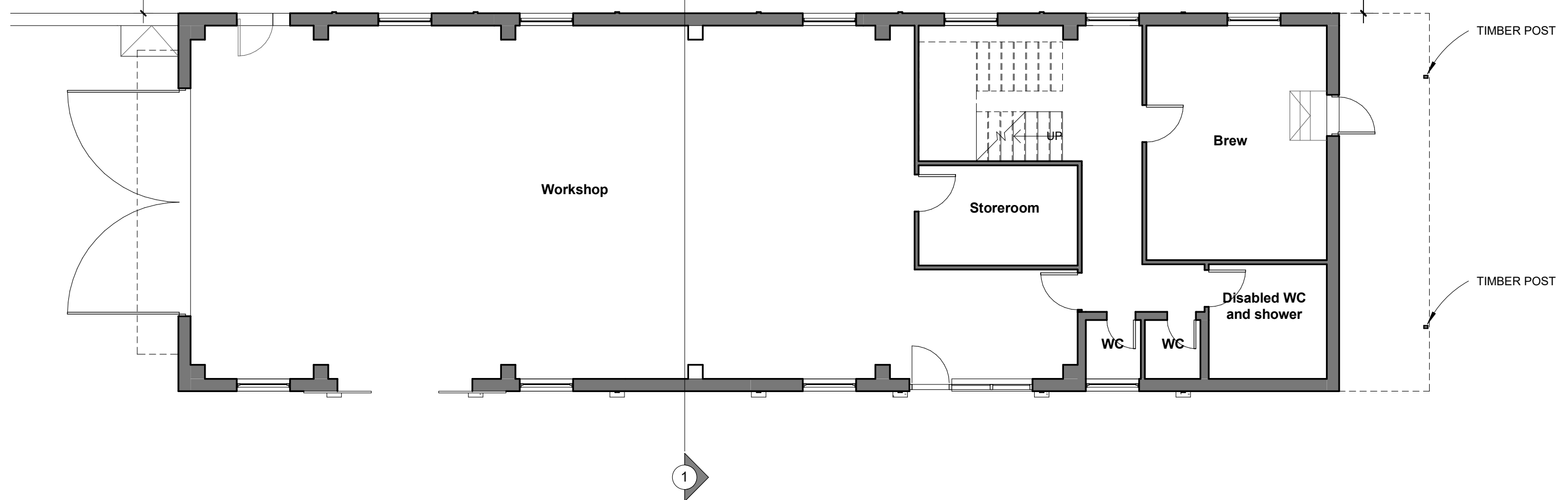

**M & P Gadsden**

Consulting Engineers Ltd

Unit 20  
Meetings Industrial  
Estate  
Park Road  
Barrow-in-Furness  
Cumbria  
LA14 4TL

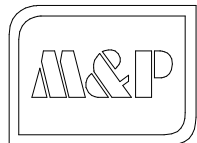

Tel: 01229 813333

Web: [www.mandpgadsdenconsulting.co.uk](http://www.mandpgadsdenconsulting.co.uk)  
E-mail: [mike@mpg-consulting.co.uk](mailto:mike@mpg-consulting.co.uk)  
[mark@mpg-consulting.co.uk](mailto:mark@mpg-consulting.co.uk)

Client: As If By Magic Ltd  
Project: Side Extension @  
Devonshire House, Devonshire Road  
Millom, Cumbria  
LA18 4JP

Rev.	Date.	Notes.	TV
A	19/03/20	Validation Amendments	TV

Notes.  
This drawing is protected by copyright and must not be copied or reproduced without the written consent of M&P Gadsden Consulting Engineers Ltd. No dimensions are to be scaled from this drawing. All dimensions and sizes to be checked on site. ©

Drawing Title.  
**EXISTING GROUND FLOOR PLANS**

Status. **PLANNING APPLICATION**

Date.	Drawn.	Scale.
28/01/2020	TV	1 : 100

Drawing No.	Revision.
19195_PL01_104	A

**LEGEND**

	Existing Structure		