

**NOTES AND AMENDMENTS**  
 This drawing is copyright ©. Figured dimensions are to be followed in preference to scaled dimensions and particulars are to be taken from the actual work where possible. Any discrepancy must be reported to the architect immediately and before proceeding.

**REVISIONS**

Rev	Description	Drawn	Date

All windows to be slim line heritage aluminium finished in Anthracite as per Alltherm Heritage Brochure included in the application information.  
 Timber windows in locations as denoted finished in Anthracite.

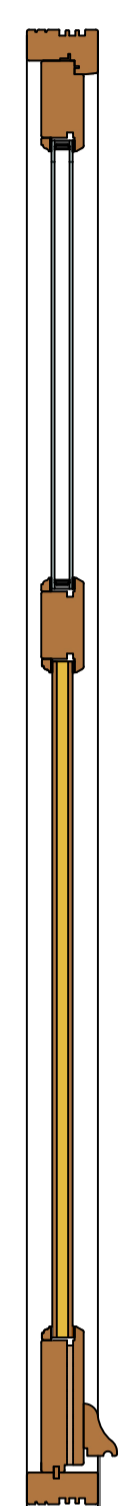
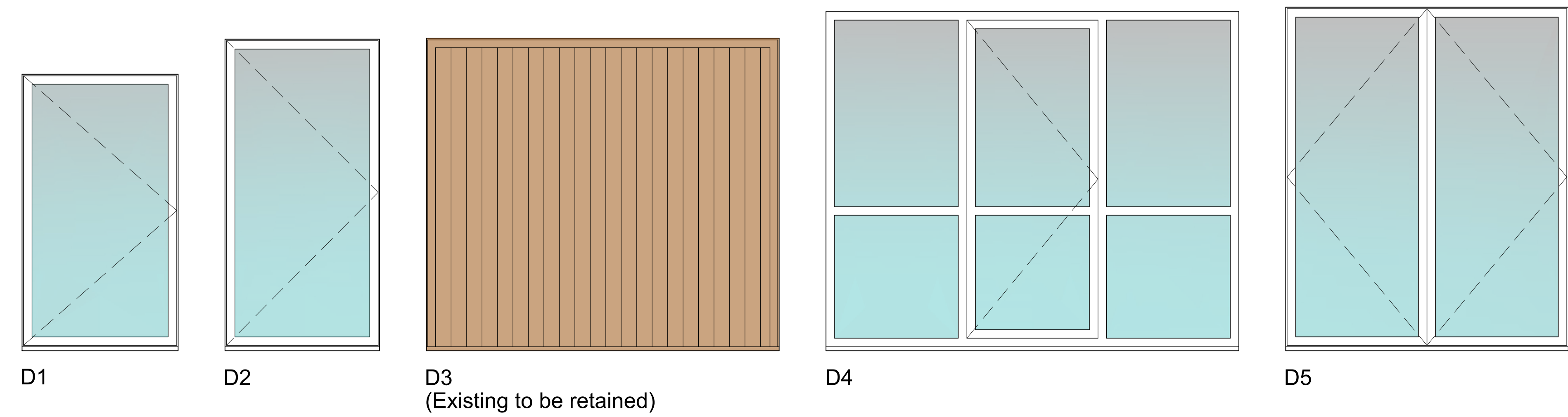
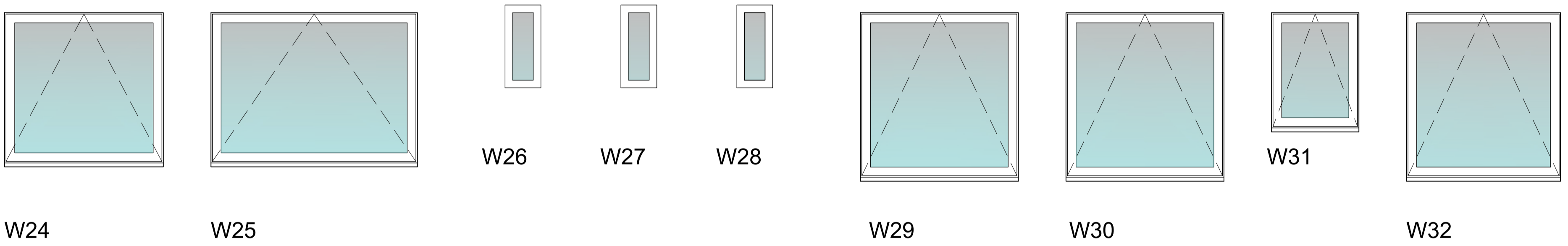
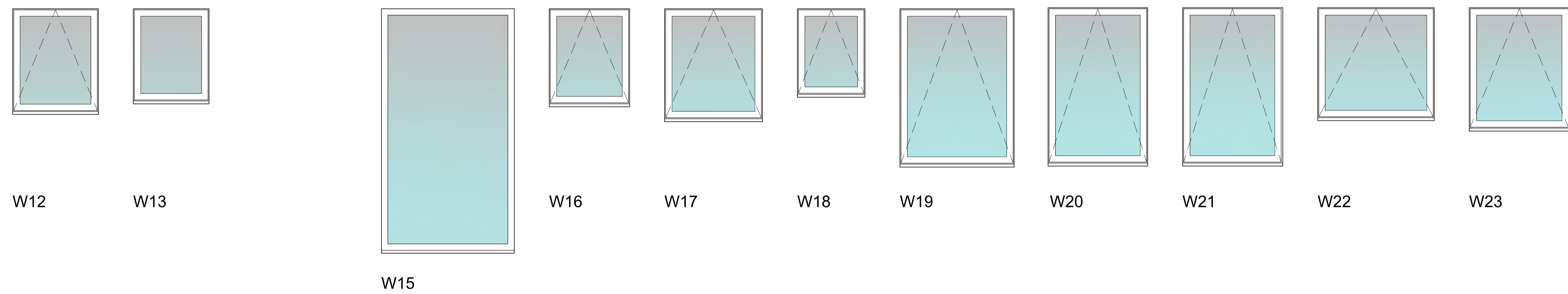
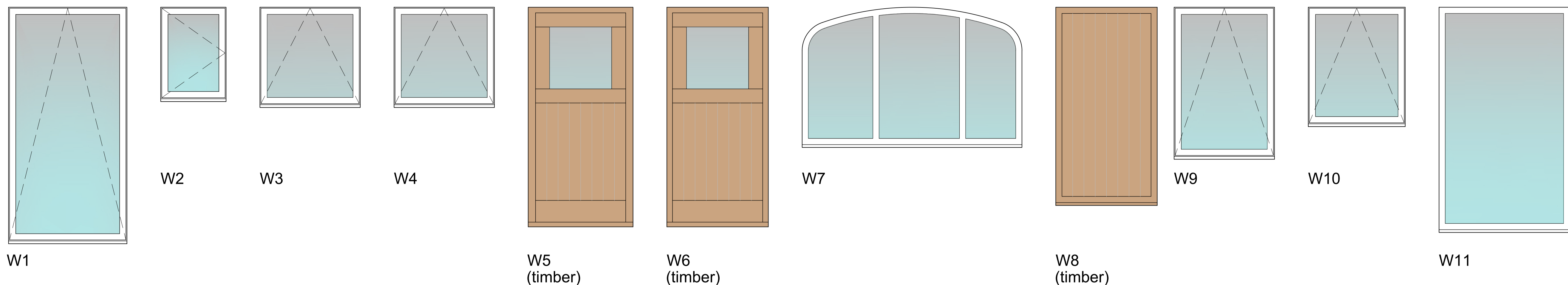

Typical Timber Window Section

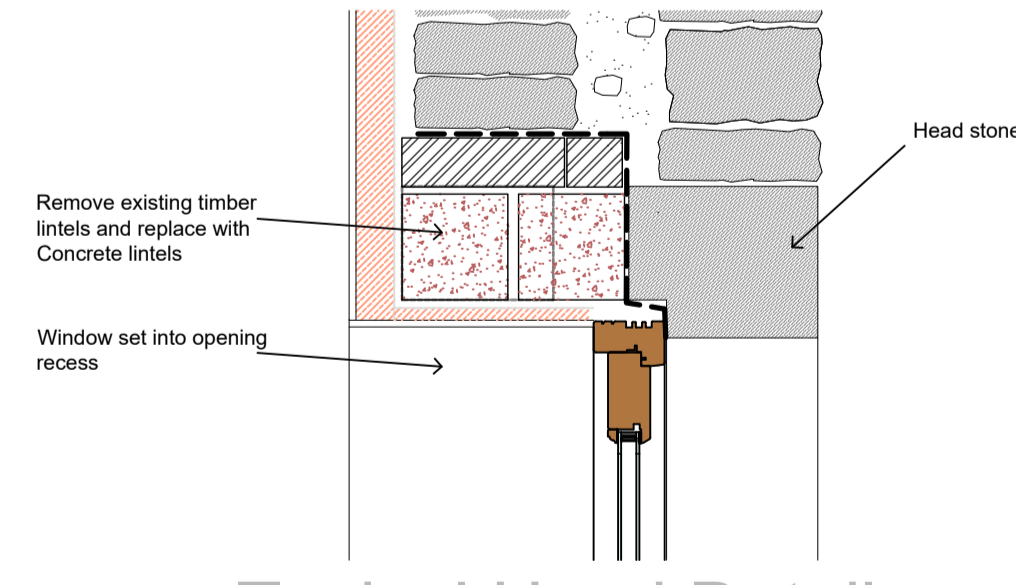

Typical Head Detail

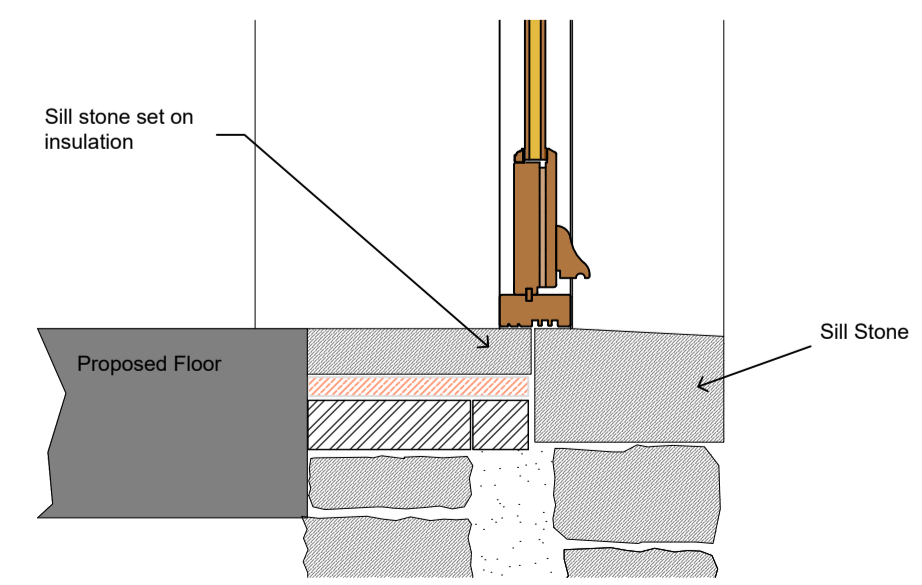

Typical Sill Detail

**ASHWOOD**  
 DESIGN ASSOCIATES LTD

Solway House Business Centre, t 01228 510616  
 Parkhouse Road, e admin@ashwooddesign.co.uk  
 Carlisle, w www.ashwooddesign.co.uk  
 CA6 4BY

**Purpose:**  
 Planning

**Client:**  
 Mr & Mrs Douglas

**Project:**  
 Orchard Brow Barn

**Title:**  
 Window Details

Scale:	Sheet Size:	Drawn:	Date:
1/20 & 1/10	A1	db	10-22
Project No:	Drawing No:	Revision:	
1903	005	a	