



# ARBORICULTURAL IMPACT ASSESSMENT

**SITE REF**  
Civic Hall, Cleator Moor

**ISSUE DATE**  
26.06.2023

**SEED REF**  
[1588-AIA-V1]

**CLIENT**  
Optimised Environments

ARBORICULTURAL CONSULTANCY  
[SEED-ARB.CO.UK](http://SEED-ARB.CO.UK)



**Seed Arboriculture Ltd**  
Suite F6.1(B), First Floor  
Adelphi Mill  
Bollington  
SK10 5JB

01625 460252  
07498 208527  
info@seed-arb.co.uk  
seed-arb.co.uk

## OVERVIEW

SEED Arboriculture Ltd were commissioned to prepare an Arboricultural Impact Assessment in relation to the Proposed Development at Civic Hall, Cleator Moor, hereafter referred to as the 'Proposed Development'.

The Proposed Development comprises of an updated landscape design with new parking, public amenity and planting scheme.

## SURVEY APPROACH

**BS5837:2012 Tree Survey:** A survey was undertaken of all trees and groups of trees within influencing distance of the red-line boundary in accordance with the recommendations of BS5837:2012.

The survey was undertaken on 13/06/2023 by Ryan Kearney FdSc.

## SURVEY SUMMARY

The survey recorded a total of 3 individual trees.

## IMPACT ASSESSMENT

In order to implement the Proposed Development, 2 Category C trees will need to be removed.

There are no new RPA incursions as a result of the Proposed Development. There is currently a hard surface pavement within the RPA of T3 which restricts root development between the tree and the new development.

New tree planting is proposed throughout the proposed landscaping scheme which will mitigate for the removal of the two low quality trees.

## RECOMMENDATIONS

The current tree pit, guard and surrounding hard-surfacing around T3 will provide as sufficient protection during the construction phase of the development.



## CAVEATS & LIMITATIONS

- The report is for the sole use of the client and its reproduction or use by anyone else is forbidden unless written consent is given by the author.
- This is an arboricultural report and as such no reliance should be given to comments relating to buildings, engineering, soils, ecological or archaeological data. If either is commented upon within the report further professional advice should be sought.
- All tree inspections were undertaken from ground level and no climbing inspections were undertaken.
- This is not a Tree Risk Assessment. As such this report should not be taken to mean or imply that any of the inspected trees should be considered safe. A Tree Risk Assessment can be provided but would be subject to additional survey requirement and further fees.
- Trees are growing dynamic structures. Whilst reasonable effort has been made to identify defects within the trees inspected, no guarantee can be given as to the absolute safety or otherwise of any individual tree. No tree is ever absolutely safe due to the unpredictable laws and forces of nature. As a result of this, natural failure of intact trees will occur; extreme climatic conditions can cause damage to even apparently healthy trees.

Kind Regards,

**Ryan Kearney FdSc**

Graduate Arboricultural Consultant



## APPENDIX 1 – TREE SCHEDULE

## BS5837:2012 TREE SCHEDULE

<u>DATE</u>	<u>CLIENT</u>	<u>SITE</u>	<u>REFERENCE</u>
15/06/2023	Optimised Environments	Civic Hall, Cleator Moor	1588-TS-001-A

Tree No.	Common Name	Botanical Name	Height (m)	Stem Dia (mm)	Crown Spread (m)				Height of Crown Clearance (m)	Age Class	Phys Con	Struc Con	Additional notes	Preliminary recommendations	BS5837 Retention Category	RPA (m <sup>2</sup> )	RPA Radius (m)
					N	E	S	W									
T1	Wild cherry	<i>Prunus avium</i>	4	270	4	2	3	4	2	Mat	Fair	Fair	Street tree with open canopy. Moderate deadwood present. Tree is currently girdled by inner ring of tree pit.	Remove to facilitate proposed development	C1	34	3.30
T2	Cotoneaster species	<i>Cotoneaster sp.</i>	2	40	1	1	1	1	0	Yng	Good	Good	Small shrub, good form	Remove to facilitate proposed development	C1	1	0.60
T3	Sycamore	<i>Acer pseudoplatanus</i>	5	100	2	2	2	2	2	Yng	Good	Good	Good form and condition	No works required	C1	5	1.20



**APPENDIX 2 – PLANS**

TREE CONSTRAINTS PLAN  
ARBORICULTURAL IMPACT PLAN



- KEY:**
- Trees / Groups
    - Canopy Spread
    - Tree Stem
    - Root Protection Area
  - A Category Tree (High quality / retention value)
  - B Category Tree (Moderate quality / retention value)
  - C Category Tree (Low quality / retention value)
  - U Category Tree (No remaining retention value)
  - Hedgerows (Not assigned BS5837:2012 category)



Rev	Description	Date
Rev A	Issue to client	15.06.2023
Rev	Description	Date



SEED Arboriculture Ltd  
 Suite F6.1, Adelphi Mill, Bollington, Cheshire, SK10 5JB  
[www.seed-arb.co.uk](http://www.seed-arb.co.uk)

**PROJECT**  
 Civic Hall, Cleator Moor

**TITLE**  
 Tree Constraints Plan

**DRAWING REF**  
 1588-TCP-001-A

**DRAWING NO**  
 001

**SCALE**  
 1:400 @ A3

**REVISION**  
 Rev A

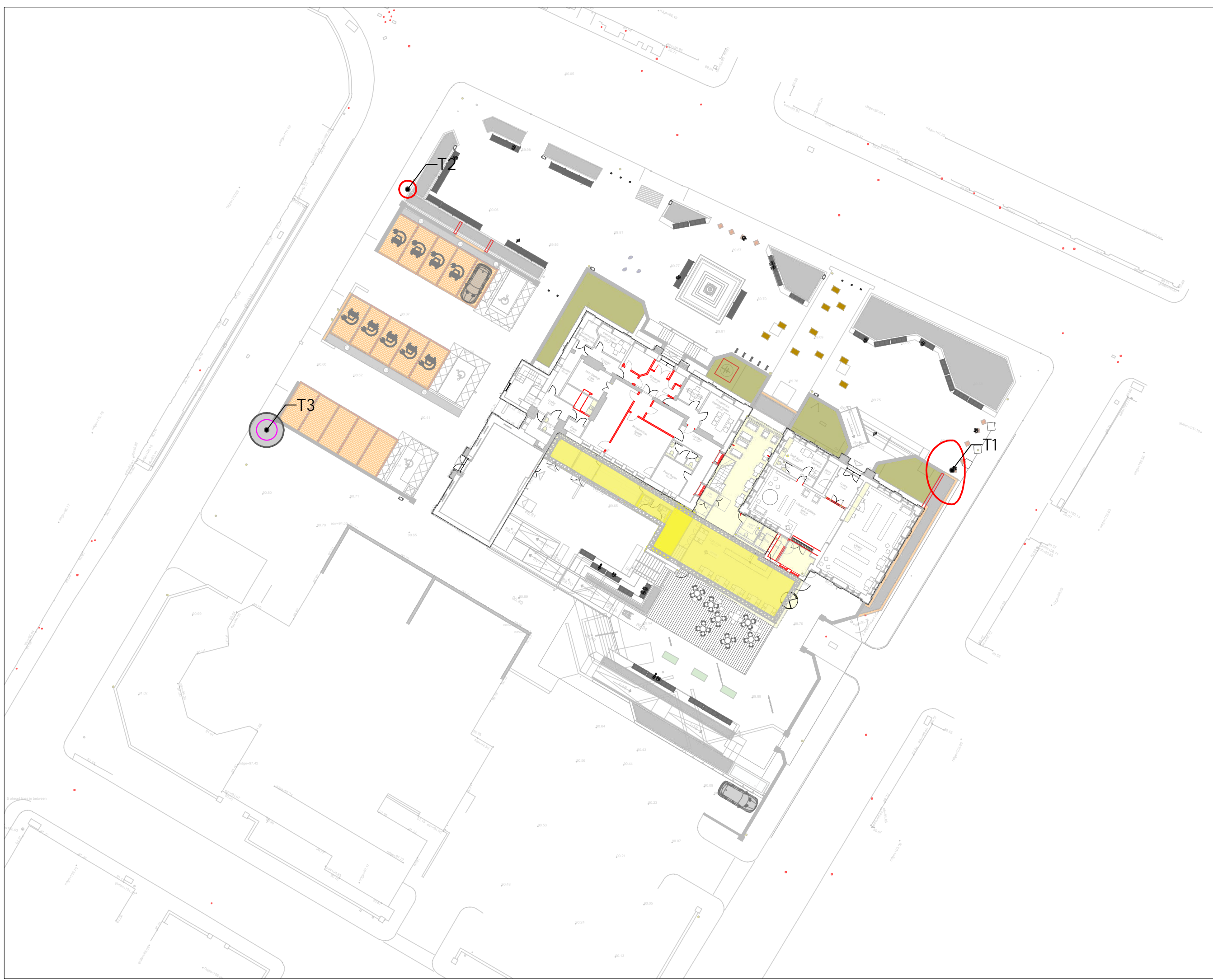

- KEY:**
- Trees / Groups
    - Canopy Spread
    - Tree Stem
    - Root Protection Area
  - A Category Tree (High quality / retention value)
  - B Category Tree (Moderate quality / retention value)
  - C Category Tree (Low quality / retention value)
  - U Category Tree (No remaining retention value)
  - Hedgerows (Not assigned BS5837:2012 category)
- ARBORICULTURAL IMPACT**
- Tree / Group to be REMOVED

Rev A	Issue to client	23.06.2023
Rev	Description	Date



SEED Arboriculture Ltd  
 Suite F6.1, Adelphi Mill, Bollington, Cheshire, SK10 5JB  
[www.seed-arb.co.uk](http://www.seed-arb.co.uk)

PROJECT Civic Hall, Cleator Moor	
TITLE Arboricultural Impact Plan	
DRAWING REF 1588-AIP-002-A	DRAWING NO 002
SCALE 1:400 @ A3	REVISION Rev A