

- Key**
- Hard Landscaping**
- Planning boundary
 - Proposed building extents
 - Yorkstone setts
125mm wide x random lengths,
175mm wide x random lengths,
tumbled finish
 - Yorkstone flush channel
300mm wide
 - Tarmacadam
 - Resin bound rubber play
surfacing
 - Natural stone boulders
with flat top for sitting
min 750wx750lx500h
 - Bench seating with back and arm
rests
metal frame with hardwood timber
 - Loose cafe tables and seating
 - Play equipment
refer to Design and Access Statement
for full details
 - Water feature
flush set in ground water jet
- Soft Landscaping**
- Proposed species rich lawn mix
150mm topsoil, 150mm subsoil
 - Proposed rain garden planting
50mm mulch, 300mm topsoil,
300mm subsoil,
400mm clean stone layer
 - Ornamental planting
50mm mulch, 300mm topsoil,
300mm subsoil
 - Ornamental shade tolerant planting
50mm mulch, 300mm topsoil,
300mm subsoil
 - Existing trees to be retained
 - Proposed trees
300mm topsoil, 600mm subsoil

- Notes**
- All dimensions in mm, unless otherwise stated.
 - Scaling from drawing if printed incorrectly may lead to errors.
 - All information outside red line boundary shown for contextual purpose only.
 - All hatch patterns are indicative only unless stated otherwise.
 - This drawing is to be read in conjunction with the following re-form landscape architecture documentation:
 - 1265-RFM-XX-00-DR-L-0002-P01-Illustrative Sections
 - 1265-RFM-XX-00-DR-L-0003-P01-Planting StrategyAND all relevant documentation from the design team
 - Levels information on this drawing illustrates the design intent. The contractor is to check and verify all levels and dimensions against site survey information.
 - Any discrepancies in the design information are to be brought to the attention of re-form landscape architecture, in writing, prior to commencement of construction works.
 - All proprietary products shall be installed in strict accordance with manufacturers written instructions.
 - Refer to other consultants' drawings and specifications for the following design information:
 - Foundation details
 - Base course and/or sub bases design & specification
 - Waterproofing of any element
 - Levels & Drainage design and infrastructure
 - Lighting and ducting
 - Existing & proposed utilities
 - Plant quantities are to suit site areas in accordance with scheduled plant densities.
 - Any proposed plant substitution shall be agreed with the landscape architect prior to ordering.

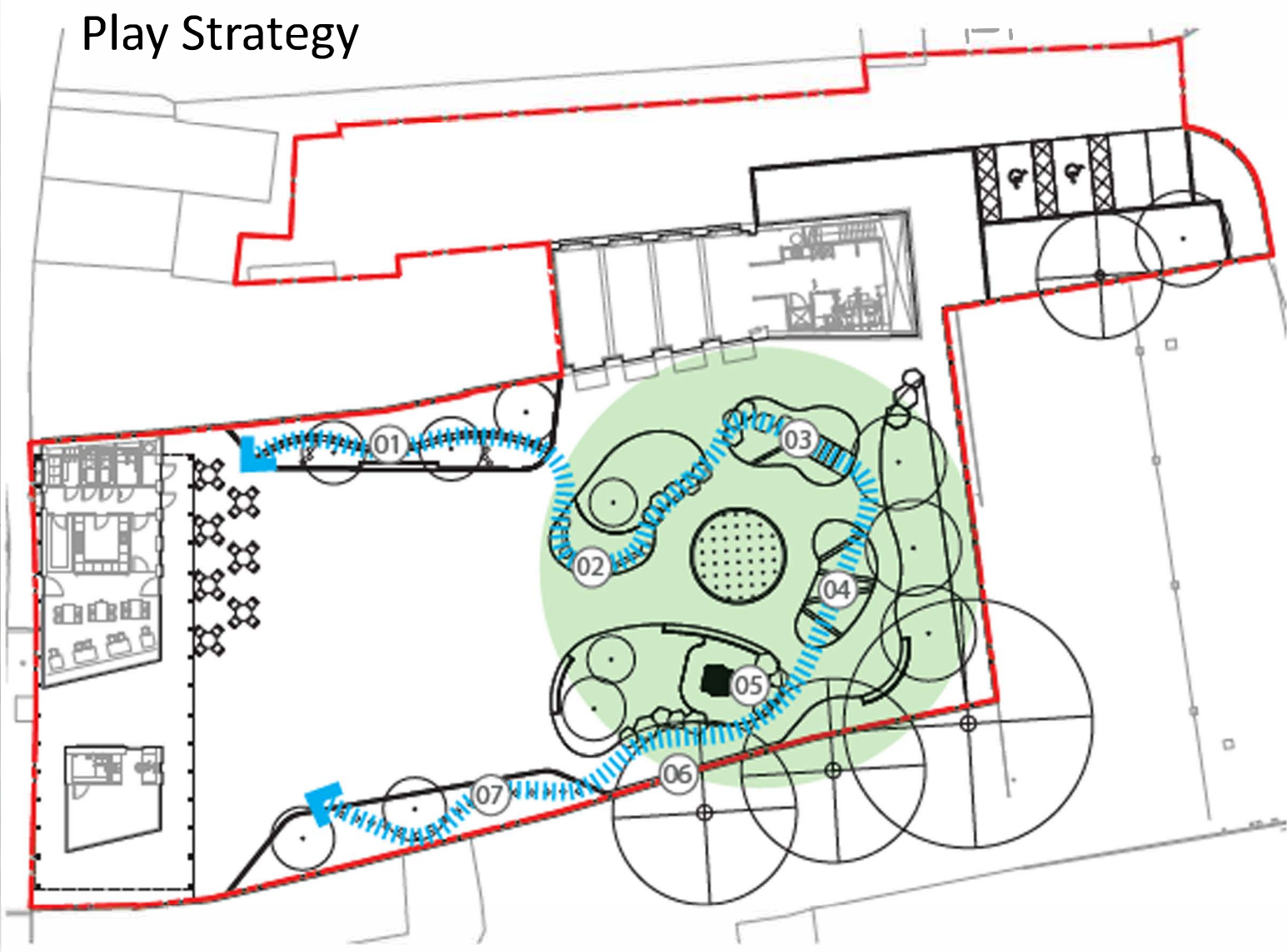

- KEY**
- 1-Boardwalk
 - 2-Tree stumps and balance beams
 - 3-Embankment slide with two approaches; stepped boulders or notched log ladder
 - 4-Bridges over rain garden
 - 5-Toddler playhouse
 - 6-Traversing wall
 - 7-Log stilts

Scale

0m 1m 2m 3m 4m 5m 6m 7m 8m

25.10.24 Issued for stage approval
Date Description of revision NS EB GD P01
Drawn by Checked by Approved by Revision

re-form
landscape architecture

Tower Works, Globe Road,
Leeds LS11 5QG
T: +44 (0)113 245 4695
E: info@re-formlandscape.com
W: re-formlandscape.com

Project
FORMER RED LION SITE, EGREMONT
RF25-1265

Client
CUMBERLAND COUNCIL

Document title
ILLUSTRATIVE MASTERPLAN

Paper size A1	Scale 1:200
Status FOR STAGE APPROVAL	S4
Drawing number 1265-RFM-XX-00-DR-L-0001	Revision P01