



Parking

The plan below illustrates the new parking



Cycle/pedestrian routes

There are two main cycle and pedestrian routes to the facility. The northern access, route 1 will allow pedestrian and cyclist to access the facility without having to traverse the car park. Access two is via the main vehicle entrance and through the car park. There are no plans to include a separate cycle path within the site boundary. There should be consideration to include crossing points in the highway outside this scheme's boundary.



Bus stops

There are no public bus stops within the site boundary. There are coaches that service the school and potential visitors (first school swimming) that have been accommodated in the design.



Service vehicle route



Active Travel

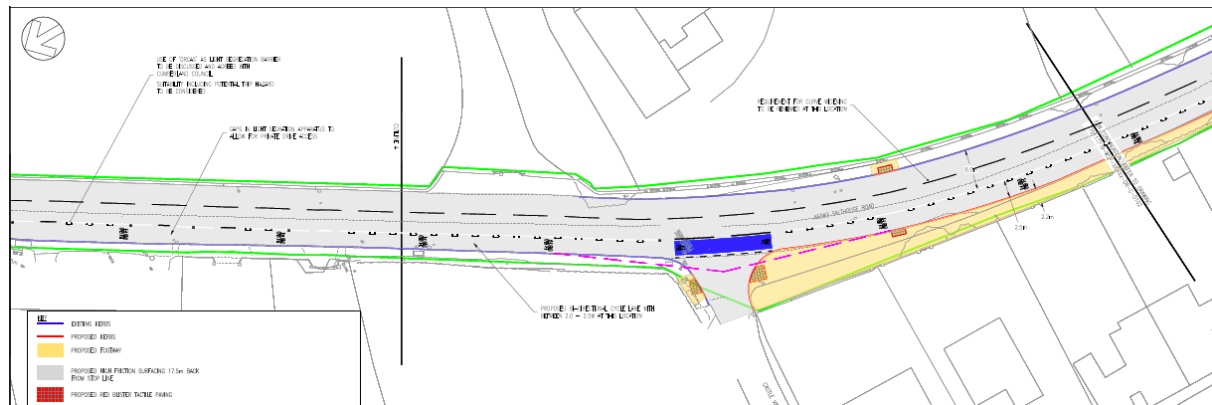

Outside the projects redline boundary there are plans to have a dedicated cycle route along Salthouse road. This project should consider a pedestrian/cycle crossing at the mouth entrance to the field to allow these users to access the facility without having to traverse the car park as noted above.