

REV	DATE	DESCRIPTION	DRW	CHK
P01	2023-10-18	First issue	Adel	MJ

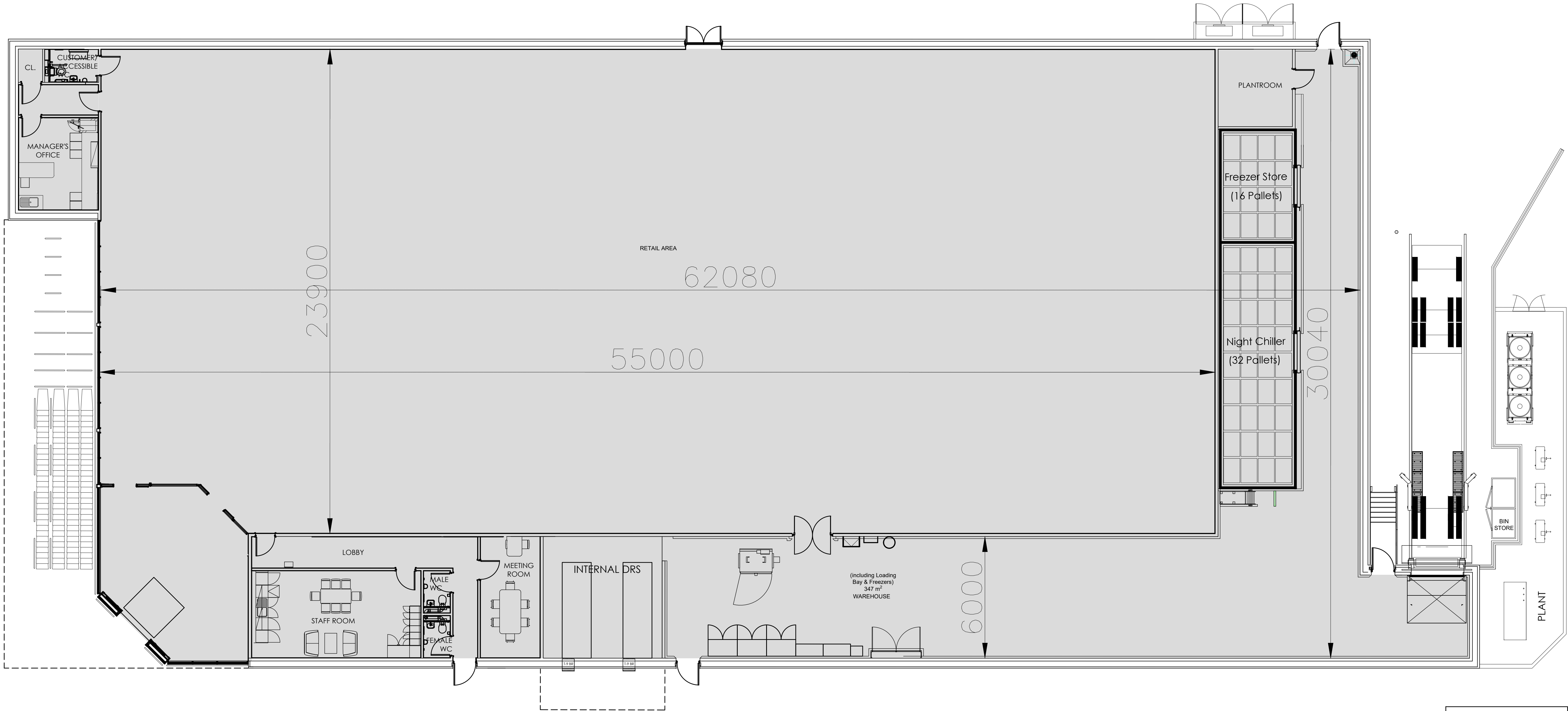

ALDI Building	
GROSS EXTERNAL FLOOR AREA (incl. loading bay, lobby, canopy)	2127 sq m
GROSS INTERNAL AREA (incl. loading bay & lobby)	1916 sq m
NET SALES AREA (incl. lobby)	1356 sq m

Client	Aldi Stores Ltd.
Project Title	Aldi - Whitehaven
Project Address	Preston Street Whitehaven



#### Proposed Floor Plan

Job No.	Originator	Zone	Level	Type	Role
0470	PA	XX	00	DR	A
System Classification	Drawing No.	Suitability	Revision		
PM_40_50-21-0003	S4	P01			
Drawn	Checked	Date	Scale	Size	
Adel	MJ	2023-10-12	1:100	A1	

Studio 303, Mailing Exchange,  
Hevitts Yard, Walker Road,  
Newcastle Upon Tyne,  
NE6 2HL

One Lochrin Square,  
92 Fountainbridge,  
Edinburgh,  
EH3 9QA

t: 0191 248 5551  
e: admin@projektarchitects.com  
w: www.projektarchitects.com

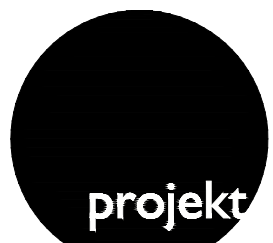

Architects | Construction

This drawing shall not be scaled and all dimensions are to be checked on site prior to work commencing. The figure dimensions are all in mm. The client shall verify the accuracy of the drawing and the project architect shall not be responsible for any errors or omissions. Any reproduction or use of this drawing without the written consent of the project architect is prohibited. Copyright of Projekt Architects Ltd.