

**STREET NAMING AND NUMBERING
NEW HOUSING DEVELOPMENT – AT WASTWATER ROAD WOODHOUSE,
WHITEHAVEN**

Lead Officer: M. Jepson, Head of Legal & Democratic Services

To ask members to decide on a street name for the proposed new housing development, at Wastwater Road, Woodhouse, Whitehaven

Recommendation: That the street name **Lowther Gardens** be adopted for the housing development and all the relevant bodies be notified.

Resources Implications: Cost of providing street nameplates if the request is approved.

1.0 SUPPORTING INFORMATION

- 1.1. The site is a development located on Wastwater Road, Woodhouse, Whitehaven and the developers wish to have a new street name adopted for this development.
- 1.2. The developer has suggested Lowther Gardens for this development. The name Lowther being associated with Whitehaven since Sir John Lowther (d.1637) acquired the manor of St. Bees which laid the foundations of their Whitehaven Estates

CONTACT OFFICER: J. Fletcher, SN&N Officer

BACKGROUND PAPERS: Street Naming file B/10

Site Layout

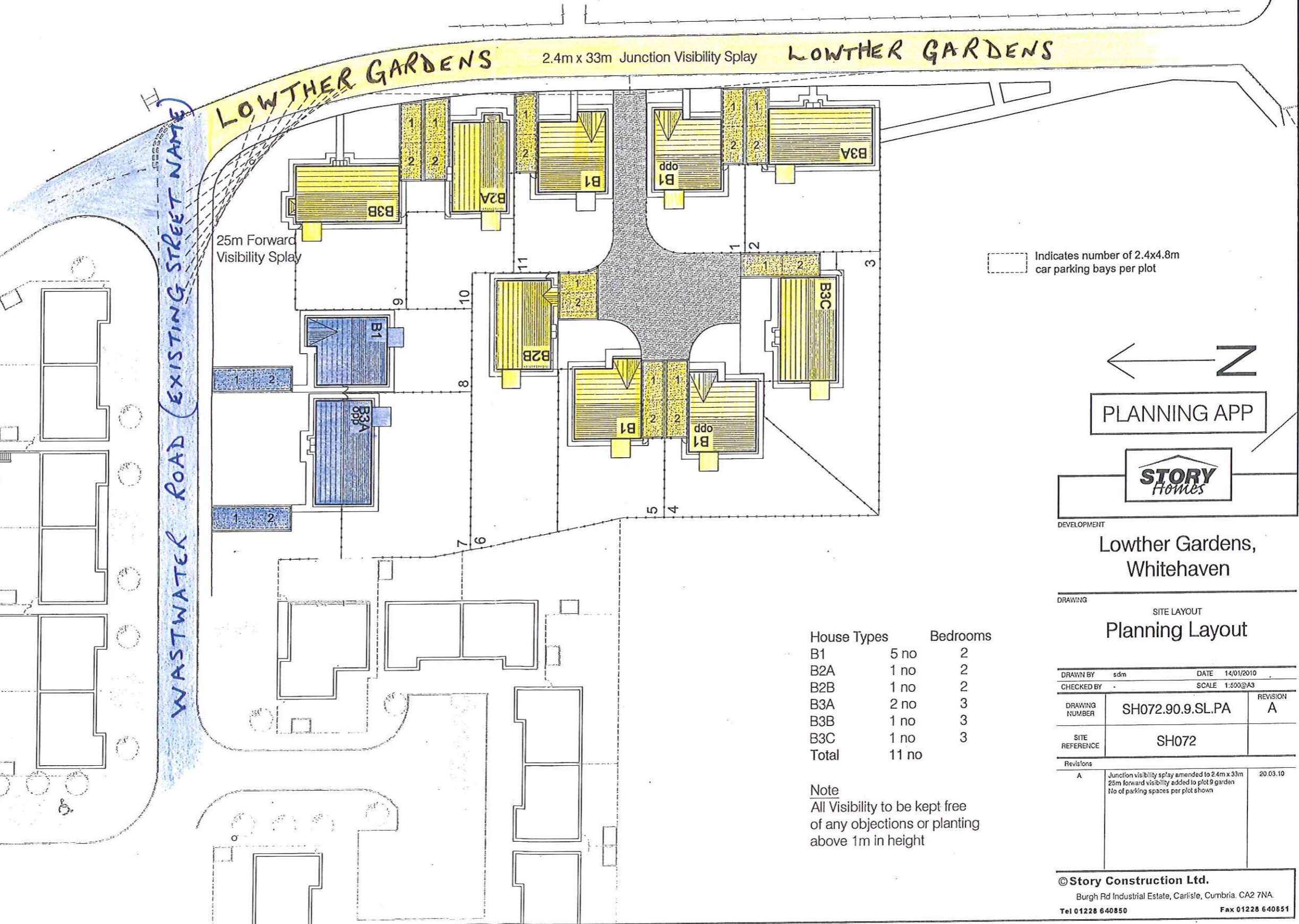

LOWTHER GARDENS 2.4m x 33m Junction Visibility Splay LOWTHER GARDENS

WASTWATER ROAD (EXISTING STREET NAME)

25m Forward Visibility Splay

Indicates number of 2.4x4.8m car parking bays per plot



PLANNING APP



DEVELOPMENT
Lowther Gardens,
Whitehaven

DRAWING
SITE LAYOUT
Planning Layout

| House Types | | Bedrooms |
|--------------|--------------|----------|
| B1 | 5 no | 2 |
| B2A | 1 no | 2 |
| B2B | 1 no | 2 |
| B3A | 2 no | 3 |
| B3B | 1 no | 3 |
| B3C | 1 no | 3 |
| Total | 11 no | |

Note
All Visibility to be kept free of any objections or planting above 1m in height

| | | | |
|----------------|------------------|----------|------------|
| DRAWN BY | sdm | DATE | 14/01/2010 |
| CHECKED BY | | SCALE | 1:500@A3 |
| DRAWING NUMBER | SH072.90.9.SL.PA | REVISION | A |
| SITE REFERENCE | SH072 | | |

| Revisions | | |
|-----------|---|----------|
| A | Junction visibility splay amended to 2.4m x 33m 25m forward visibility added to plot 9 garden No of parking spaces per plot shown | 20.03.10 |

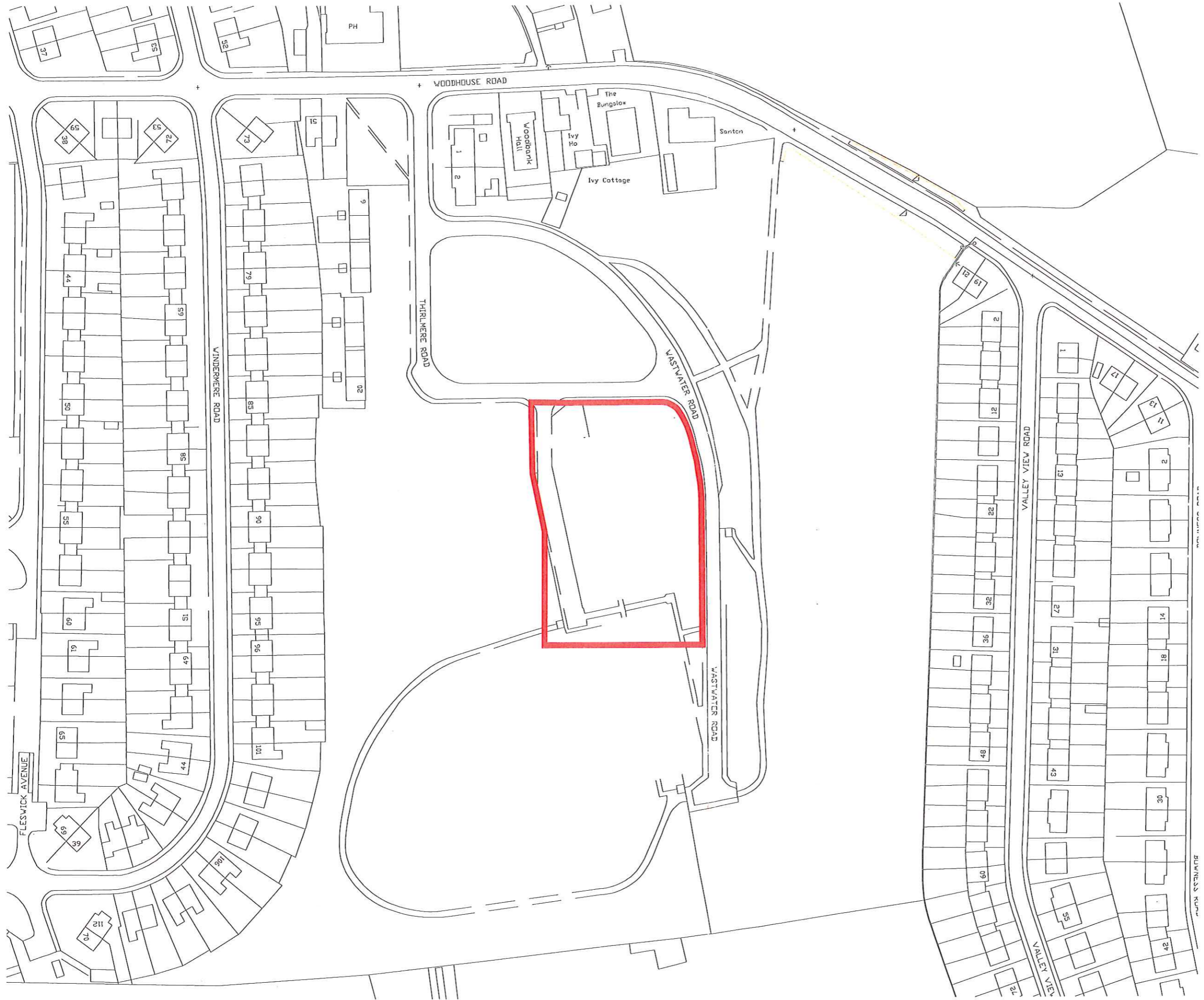

PLANNING APP



DEVELOPMENT **Lowther Gardens,
Whitehaven**

DRAWING **Site Layout**

Location Plan

| | | | |
|-----------------------|------------------|------------|-------------|
| DRAWN BY | sdm | DATE | 03/07/09 |
| CHECKED BY | | SCALE | 1:1250 @ A3 |
| DRAWING NUMBER | SH072.90.9.SL.LP | REVISION | - |
| REGION SITE REFERENCE | SH072 | MASTER REF | 1 |
| Revisions | | | |