

**PROPOSED DIVERSION OF PUBLIC BRIDLEWAY NOS. 410019 & 403099 (410099)
PARISH OF HAILE & WILTON & CLEATOR MOOR**

Lead Officer: Tony Pomfret – Development Services Manager

To inform Members of the proposed diversion of Public Bridleway Nos. 410019 & 403099 (410099), Parish of Haile & Wilton & Cleator Moor

Recommendation: That the proposal be supported.

Resource Implications: Nil.

1.0 SUPPORTING INFORMATION

- 1.1 The Council has been consulted by Capita Symonds, on behalf of Cumbria County Council, in respect of a proposed bridleway diversion to the north east of Wilton, a copy of which is appended to this report.
- 1.2 The diversion is sought under the Highways Act 1980 and is for the benefit of the applicant.
- 1.2 The proposal would divert the route for a distance of 800 metres. The proposed route would follow an existing stone surfaced track and would have a width of 3.0 metres throughout.
- 1.3 As there is reasonable justification for this proposal, it is considered worthy of support.

Contact Officer: Rachel Carrol, Planning Officer

Appendix: Capita Symonds consultation letter and accompanying plan dated 9 December 2008.

CAPITA SYMONDS

9th December 2008

Our reference: HW/410019
Enquiries to: Hazel Wainwright
Direct Line: 01228 673257
Email: hazel.wainwright@capita.co.uk

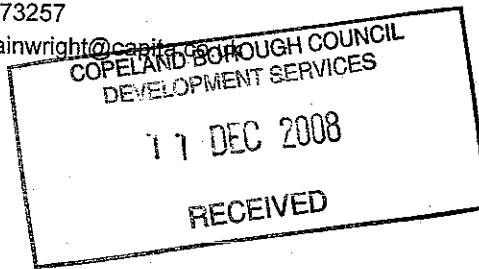

Planning Services
The Copeland Centre
Catherine Street
Whitehaven
Cumbria
CA28 7SJ

Capita Symonds Ltd
The CAPITA building
Kingmoor Business Park
CARLISLE CA6 4SJ.

tel 01228 673000 fax 01228 673111
email: enquiries.capitasymonds@CAPITA.co.uk
www.capitasymonds.co.uk

Dear Sir

**PROPOSED DIVERSION OF PUBLIC BRIDLEWAY Nos. 410019 & 403099 (410099)
PARISH OF HAILE & WILTON & CLEATOR MOOR
DISTRICT OF COPELAND**

I will be pleased to receive any comments that your council might wish to make regarding the proposed diversion of above-mentioned bridleway, as shown on the attached plan.

Description of the Existing Route (with reference to the plan)

From point 'A' on a stone track the existing route runs through a gate in a generally north-easterly direction along the top of a field, then crossing a fenceline and gullied stream to turn north and then northwest steeply down the hill to Uldale Farm. It then crosses another fenceline turning back east-north-easterly alongside Kirk Beck until it reaches a hard track and follows this to point 'B', a total distance of approximately 850 metres.

Description of Proposed Route (with reference to the plan)

From point 'A' the proposed route would follow an existing stone surfaced track running generally north east turning north and then west down the hill to point 'B' where it rejoins the route to remain, a total distance of 800m. The new path width is to be 3m throughout.

Reason for Diversion

As is permitted under the Highways Act 1980 the diversion is for the benefit of the applicant.

Yours sincerely



Hazel Wainwright
Access Consultant
Enc.

Capita Symonds Ltd is contracted to provide Rights of Way management services for Cumbria County Council

The Capita Building, Kingmoor Business Park, Carlisle, Cumbria, CA6 4SJ
Tel 01228 673000 Fax 01228 673111
www.capitasymonds.co.uk
Capita Symonds Ltd

Uldale

Number:

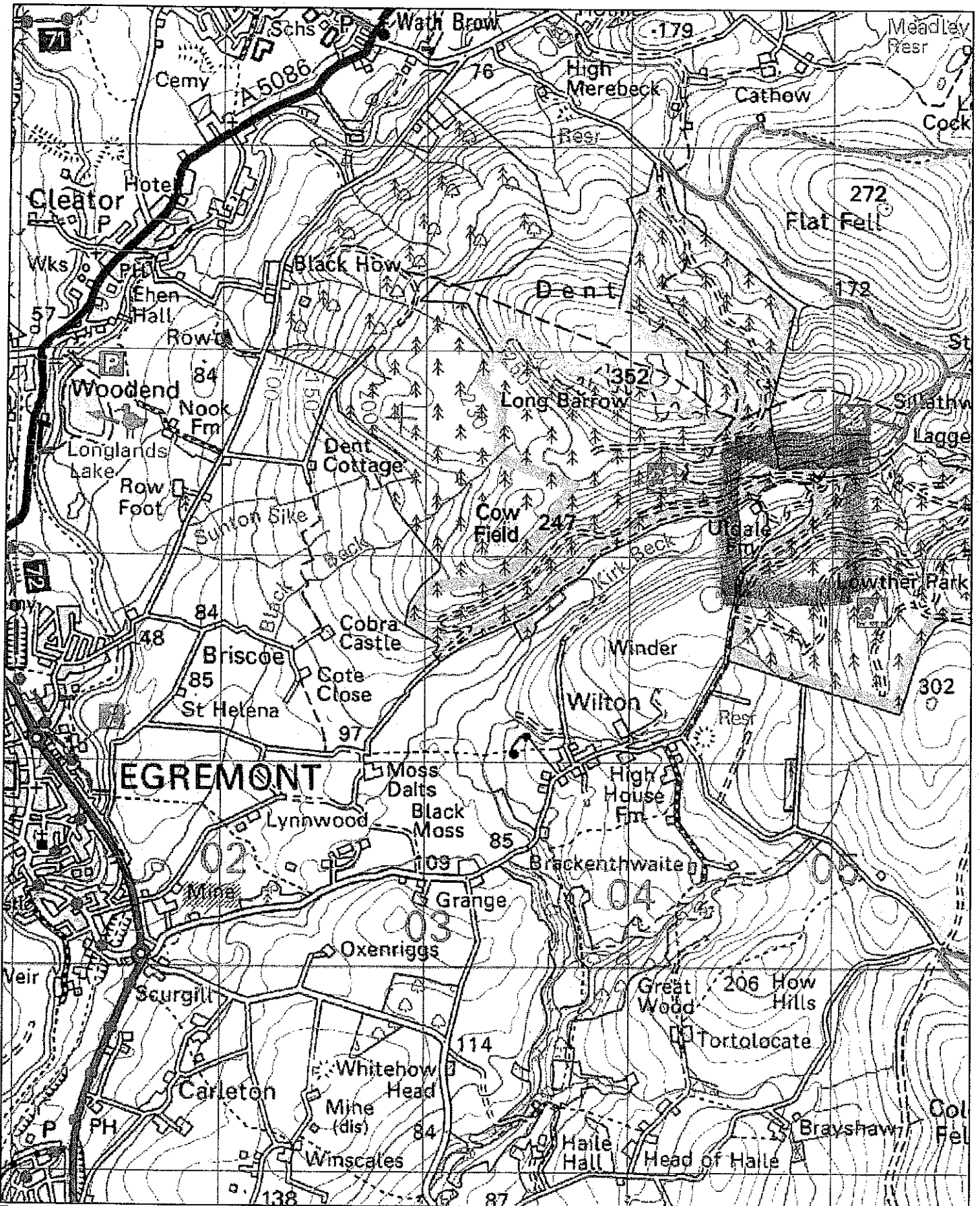

Countryside and Heritage Management Services

Scale :1:25,000

This produce includes mapping data licenced from Ordnance Survey.
(c) Crown Copyright 2006. Licence Number 100019596

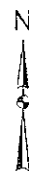

CAPITA SYMONDS

The Capita Building
Kingmoor Business Park
Carlisle
Cumbria
CA6 4SJ

Tel. 01228 673179

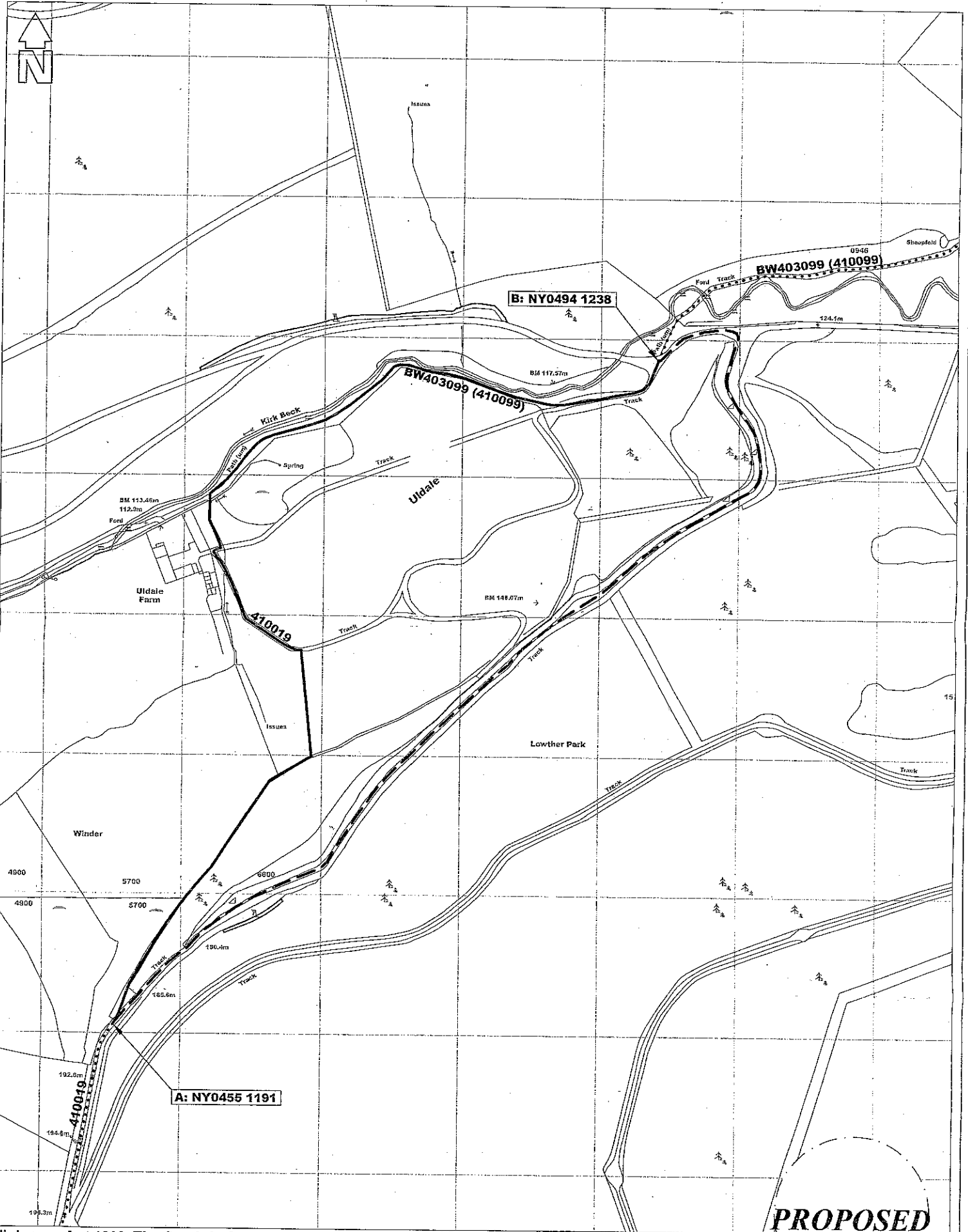

Highways Act 1980, The Cumbria County Council
Parishes of Haile & Wilton & Cleator Moor
Public Bridleway Nos 410019 & 403099 (410099)
PUBLIC PATH DIVERSION ORDER
DISTRICT OF COPELAND

KEY
 Footpath to be Extinguished ————
 Footpath to be Created - - - - -
 Footpath to Remain
 Head of Legal Services

