

ARLECDON & FRIZINGTON PARISH COUNCIL

Clerk: Mrs GA Everett
Tel: 01946 811182

Ain Garth
Main Street
FRIZINGTON
Cumbria
CA26 3PQ



17 March 2006

Mr T Pomfret
Development Services Manager
Copeland BC
The Copeland Centre
Catherine Street
WHITEHAVEN
Cumbria

Dear Mr Pomfret

PLANNING APPLICATIONS

4/06/2043/0 3 bedroom extension for Mr & Mrs Young 8 Rheda Close, Frizington
The Parish Council is concerned about the proliferation of large extensions on this estate and requests a site visit.

4/06/2047/0 Residential dwellings land at St Paul's Ave, Frizington for Copeland BC
The Parish Council believes this is an inappropriate development on a green space in the village.

4/06/2058/0 Ground and first floor extension at 21 Arlecdon Rd for Mr S Dixon
No objection

Yours sincerely

Clerk

4/06/2047/0

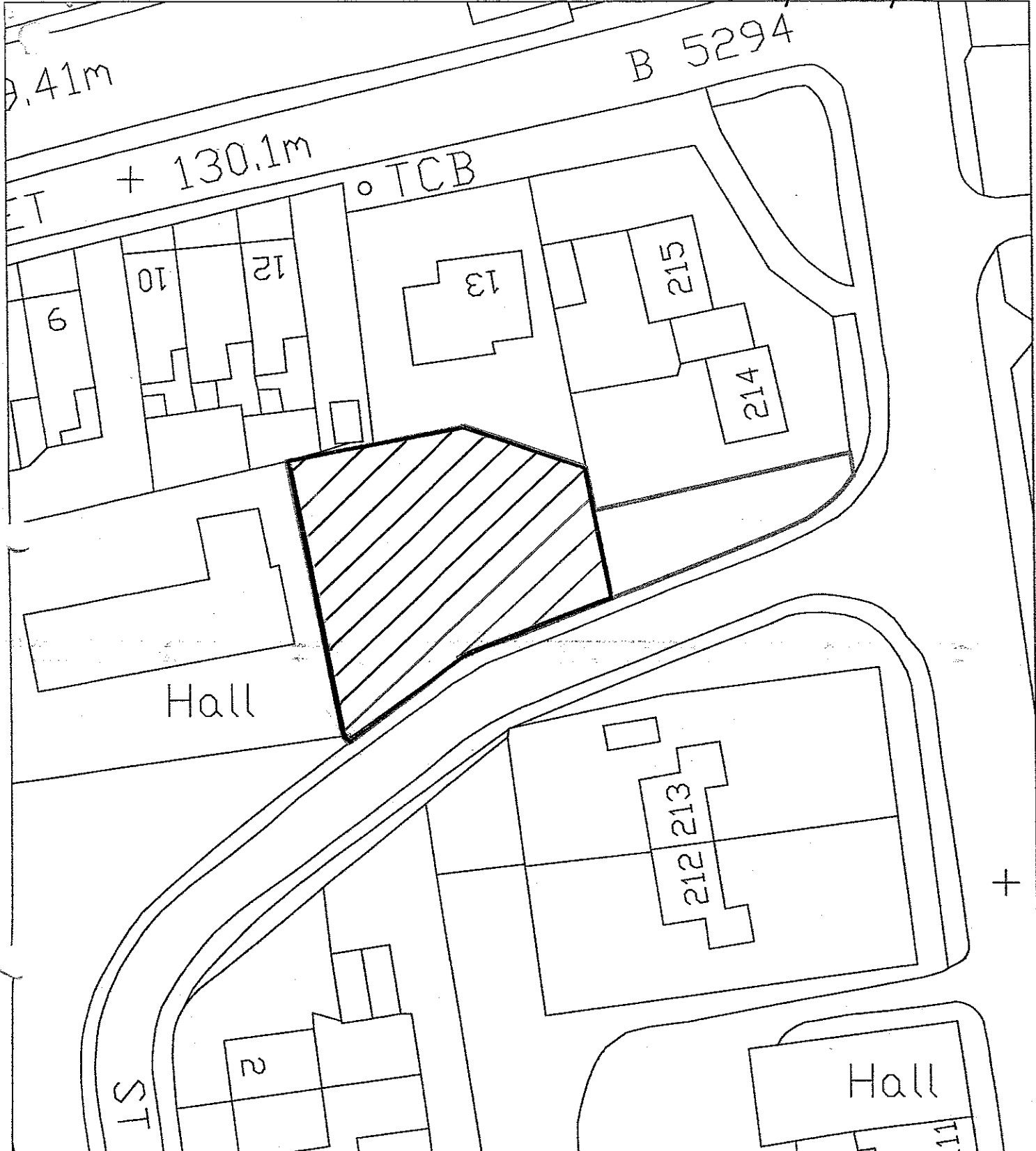

Copeland Borough Council

Scale: 1:500 O.S: NY0316

C/O Capita Symonds
 The Capita Building
 Kingmoor Business Park
 Carlisle
 CA6 4SJ



Land at St Pauls Avenue
 Frizington

AMENDED PLAN

COPELAND BOROUGH COUNCIL

24 FEB 2006

RECEIVED